

- Steps:
- 1) Attach plex counter to top of counter base, using standoff barrels.
  - 2) Connect power cords to Supernova lights in counter.
  - 3) Apply SEG graphic to front of counter.

**\* Plex Counter Attachment**

Attach stand-off barrels to primary counter top. Connect plex counter to primary counter top using screw caps.

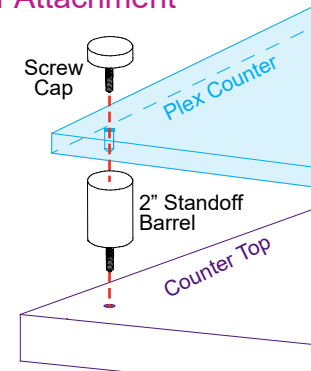

**\*\*DO NOT OVER TIGHTEN. PLEX WILL CRACK\*\***

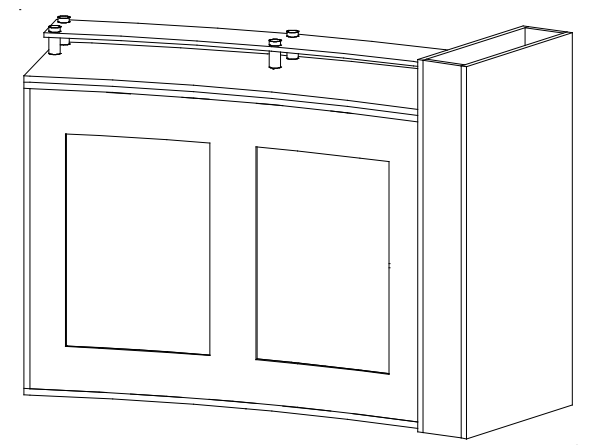
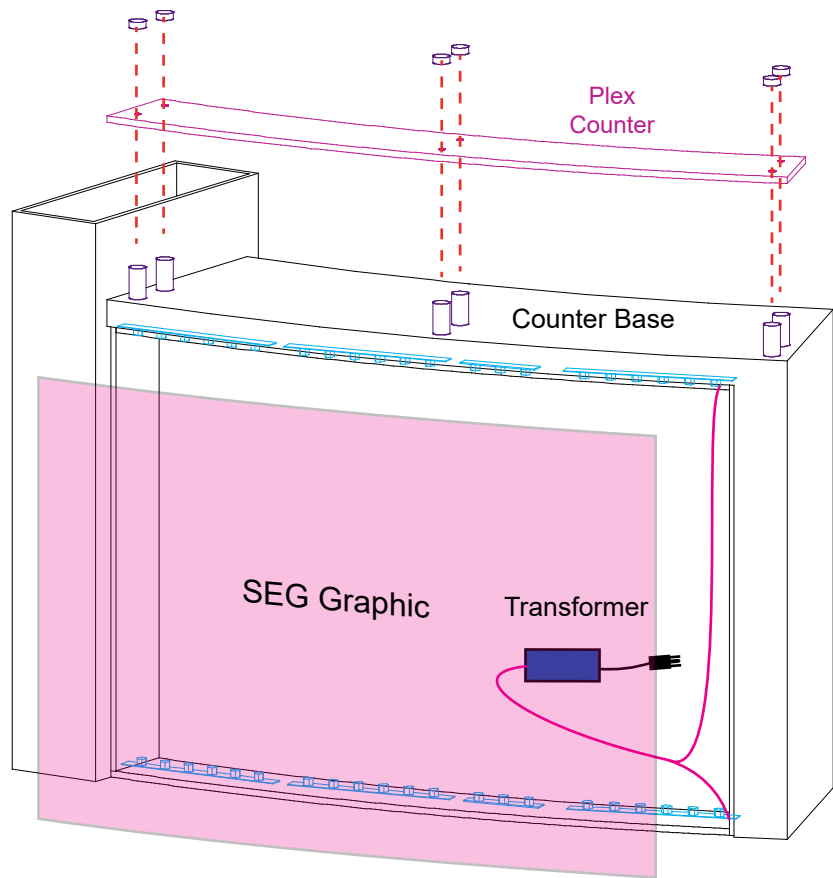

BACK VIEW

FRONT VIEW

**Light to Light Attachment**

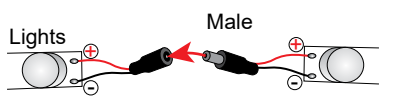

**Light to Transformer Attachment**

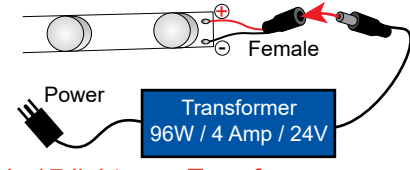

Transformer  
96W / 4 Amp / 24V

Maximum of 7 lights per chain / 7 lights per Transformer

# SETUP INSTRUCTIONS

# SEG Graphic Installation *in 3 Steps*

*The Perfect Fit*

## STEP 1: Attach Corners

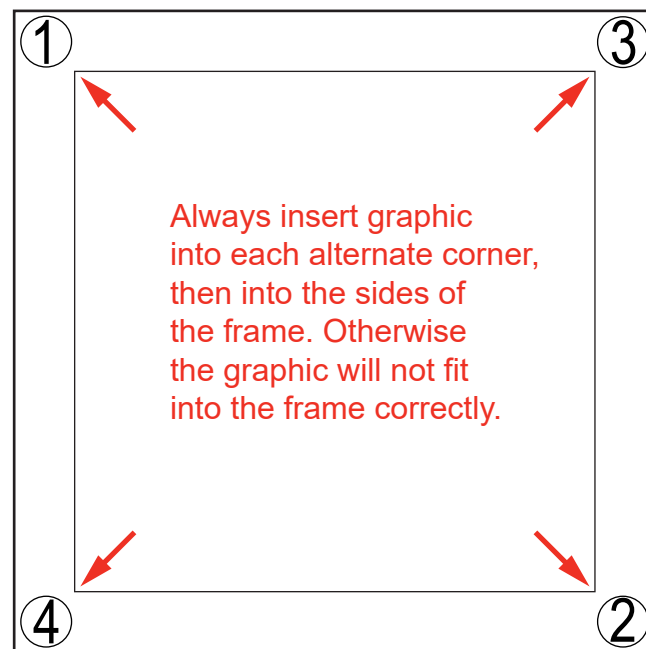

## STEP 2: Attach Middle

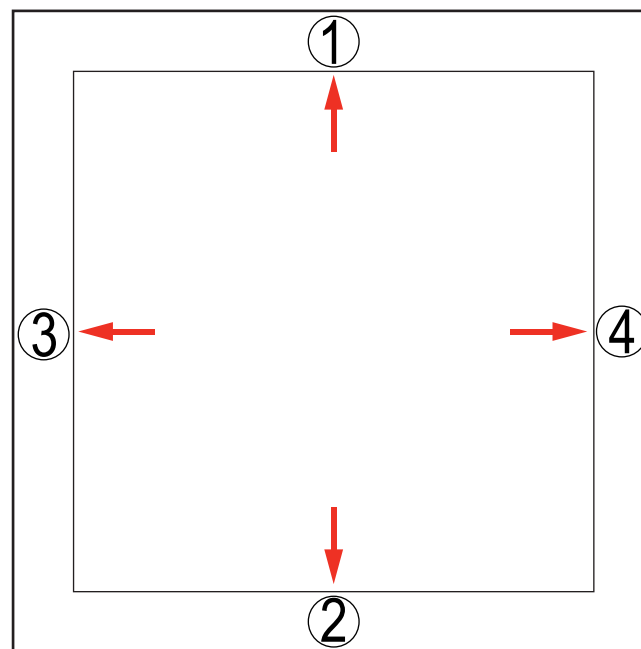

## STEP 3: Attach Sides

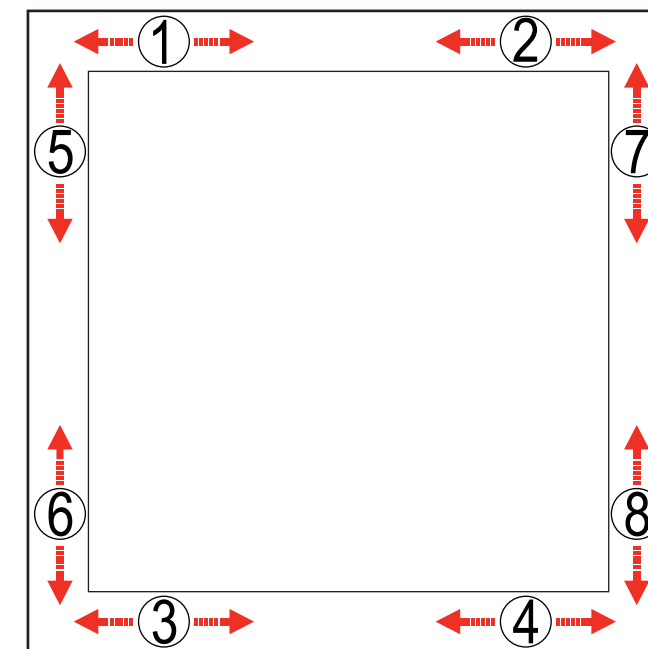

Insert narrow side of silicone welt into the channel at corner 1, with fabric to the outside.

Repeat for opposite corner 2, then corner 3, then corner 4.

Once corners are attached, press the middle of edge 1 into the channel. Then press middle of edge 2 into the channel on opposite side.

Repeat with edge 3 & 4.

Once the middle of sides are attached, fully press the silicone welt into the channel, between center and corner at location 1. Repeat the process between center and corner at location 2.

Do the same for welt on opposite side, at locations 3 & 4. Then repeat for locations 5 & 6 and 7 & 8.

Once the welt is fully inserted on all sides, smooth out edges as needed for a perfect fit.



To remove the graphic from the frame, locate the fabric **pull tab**. Gently pull on the tab to remove the graphic.

Install video:



CRATE PACKING